

SM-WPCS | Water-Resistant Case for Mobile Phones and Smartphones



SM-WPCS
Water-resistant
Mobile Phone Case



Set Screw

Package Contents:

- (1) SM-WPCS - Water-Resistant Mobile Phone case
- (1) Set Screw

Case included is Universal, designed to fit nearly ALL non-flip mobile phones regardless of whether a protective case or silicone sleeve is attached to the phone.

- Most smartphones, mobile phones, and cell phones
- Apple iPhone - All models
- RIM BlackBerry - All non-flip models
- HTC Phones - All non-flip models
- Motorola Phones - All non-flip models
- Nokia Mobile Phones - All non-flip models
- Palm - All non-flip models
- LG Mobile Phones - All non-flip models
- Samsung - All non-flip models
- Sony Ericsson - All non-flip models
- Sanyo - All non-flip models
- Pantech - All non-flip models
- Google - All non-flip models

*All brand names and product names are trademarks or registered trademarks of their respective owners.

Connecting the Water-Resistant Case to a Pedestal

⚠️ Caution: A set screw has been provided to be installed into the back side of the water resistant case to secure it to the handlebar pedestal. Ensure that the screw is properly installed to prevent the case from falling from the pedestal.

Step 1. Connect the dual T-slots (A) on case to the dual T-tabs (B) on any Arkon dual-T pedestal head (sold separately). Insert the set screw (C) into the set screw hole (D) and screw in tightly to prevent the case from slipping off the pedestal head.

*Not a complete solution by itself. See www.arkon.com for compatible dual T-tab pedestals.

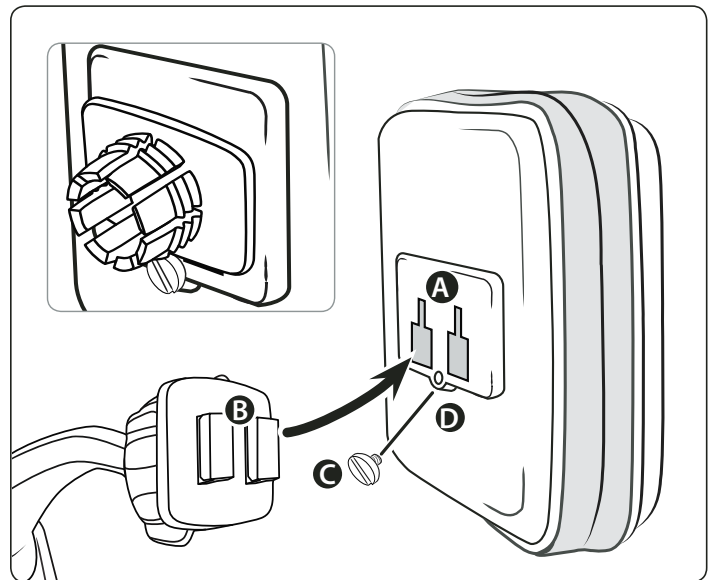

*Set screw ensures secure connection to dual-T mount.

ARKON[®]
RESOURCES INC. The Mobile Mounting Specialists™

Consumer Hotline:

USA (800) 841-0884

INT'L (626) 254-9005

Monday - Friday 9am - 5pm, PST

www.arkon.com

Arcadia, CA 91006 USA

Designed in USA | Made in China

© Copyright 2010 Arkon Resources, Inc.